

1"  
[25.4mm]

3/4"  
[19.05mm]

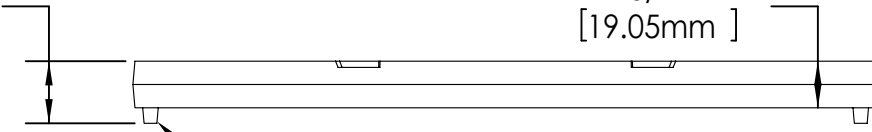

Grinding pads for final level  
file or grind down if needed to prevent grate rock

12"  
[304.8mm]

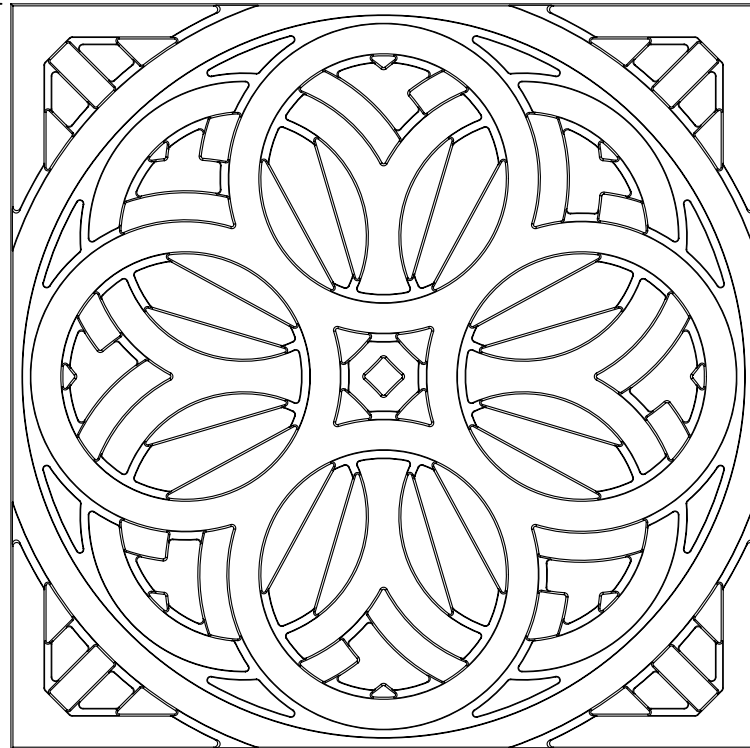

12"  
[304.8mm]

## 9055DR-12 DEL SOL 12" Drain Grate

Drain Grate for Pedestrian loads only.

1/2" maximum slot opening for A.D.A. compliance and pedestrian safety.

Cast from Gray Iron, or Aluminum from 100% Recycled Materials. Or Brass alloy C854 yellow brass

Finish: Unfinished, or Black Dip, or Enamel Paint, or Polyurethane Paint, or Powder Coat.  
Zinc undercoat available.

Specify finish and color.

Use Frame Model:  
9000FDR-12-X

Clear opening:  
25 sq.in.

Weight per Each  
Iron: 14 lb./ 6.3 Kg.  
Aluminum: 5 lb./ 2.25 Kg.  
Brass: 17 Lb. 7.6 Kg.

DO NOT SCALE DRAWING

**IRONSMITH**  
41-701 Corporate Way #3  
Palm Desert, CA 92260  
(800) 338-4766  
(760) 776-5080 Fax

### PROPRIETARY AND CONFIDENTIAL

This drawing embodies a confidential design of IRONSMITH, INC. Palm Desert, CA. All design, manufacturing, reproduction, use, sale, and other rights regarding the same are expressly reserved. This drawing is submitted under confidential relationship for a specific purpose and the recipient agrees by accepting this drawing not to supply or disclose any information regarding it to any unauthorized person or to incorporate any special feature peculiar to this design in other projects. The information in this drawing may be covered completely or in part by patents pending.